

DAI 500.40.28 Attachment A - DentaPure Installation Instructions
Effective Date: 06/08/15

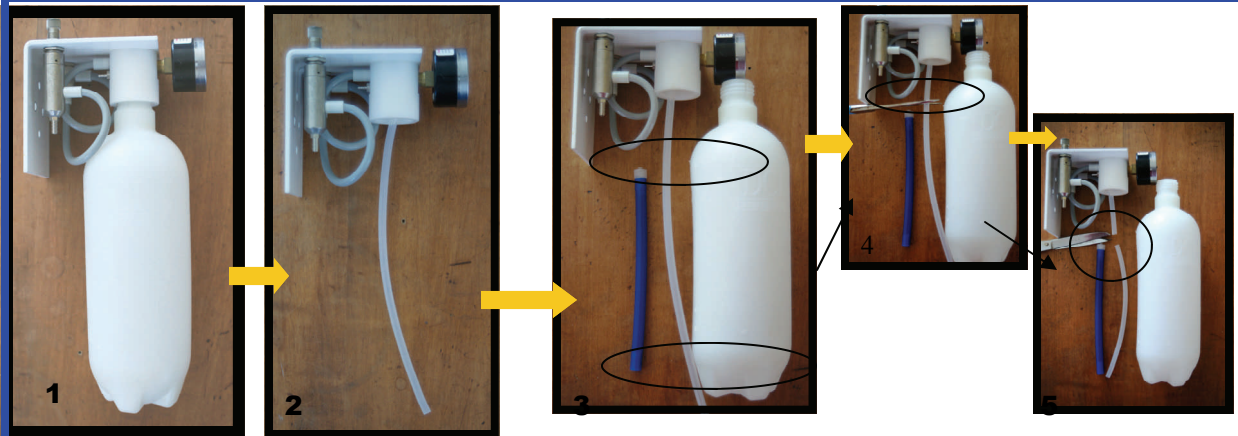

Turn pressure off and remove bottle

Note pickup tube

Hold up the DentaPure next to the bottle and pickup tube, so the DentaPure is just off the bottom of the bottle. Cut the pickup tube as shown.

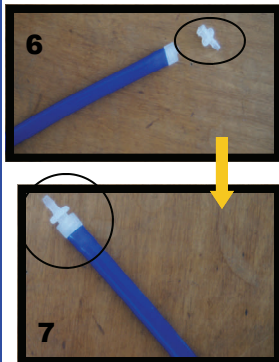

Take the male fitting and screw it onto the DentaPure Cartridge. Using the cartridge as a handle, carefully push the fitting into the now short pickup tube.

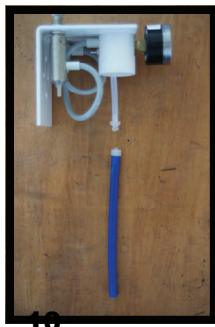
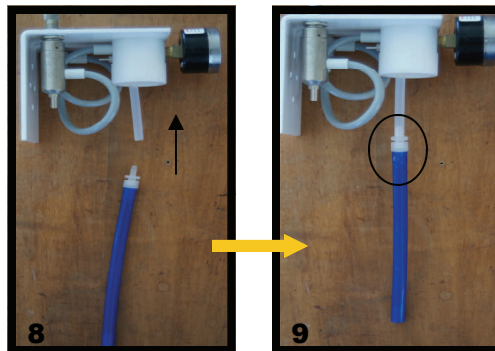

The DentaPure is now installed. To change it the next time, just unscrew the cartridge from the fitting and put a new one on.



Fill the bottle with water and put it back onto the fitting.

Turn the pressure back on if the bottle will be in use.

You are done!

Remember that for longer two liter bottles, all you have to do is cut the pickup tube longer. You want to end up with the bottom of the DentaPure Cartridge just 1/4 of an inch above the bottom of the bottle.

Install the female fitting on the pickup tube you cut off. That tube can then be used to apply medicaments or other solutions, if needed.

